

Achtung ! Gläser niemals ungeschützt auf den Boden stellen.
Verletzung der Glaskante führt zu Glasbruch.

Caution ! Never put glass walls on the floor without protection.
Damaging the glass edges results in breaking of the glass.

Attention ! Jamais placer des parois de douche en verre au sol sans
protection. Des verres endommagés casseront.





Achtung ! Gläser niemals ungeschützt auf den Boden stellen.
Verletzung der Glaskante führt zu Glasbruch.

Caution ! Never put glass walls on the floor without protection.
Damaging the glass edges results in breaking of the glass.

Attention ! Jamais placer des parois de douche en verre au sol sans protection. Des verres endommagés casseront.

Zum Aufbau benötigen Sie
for mounting you need
pour l'installation il vous faut

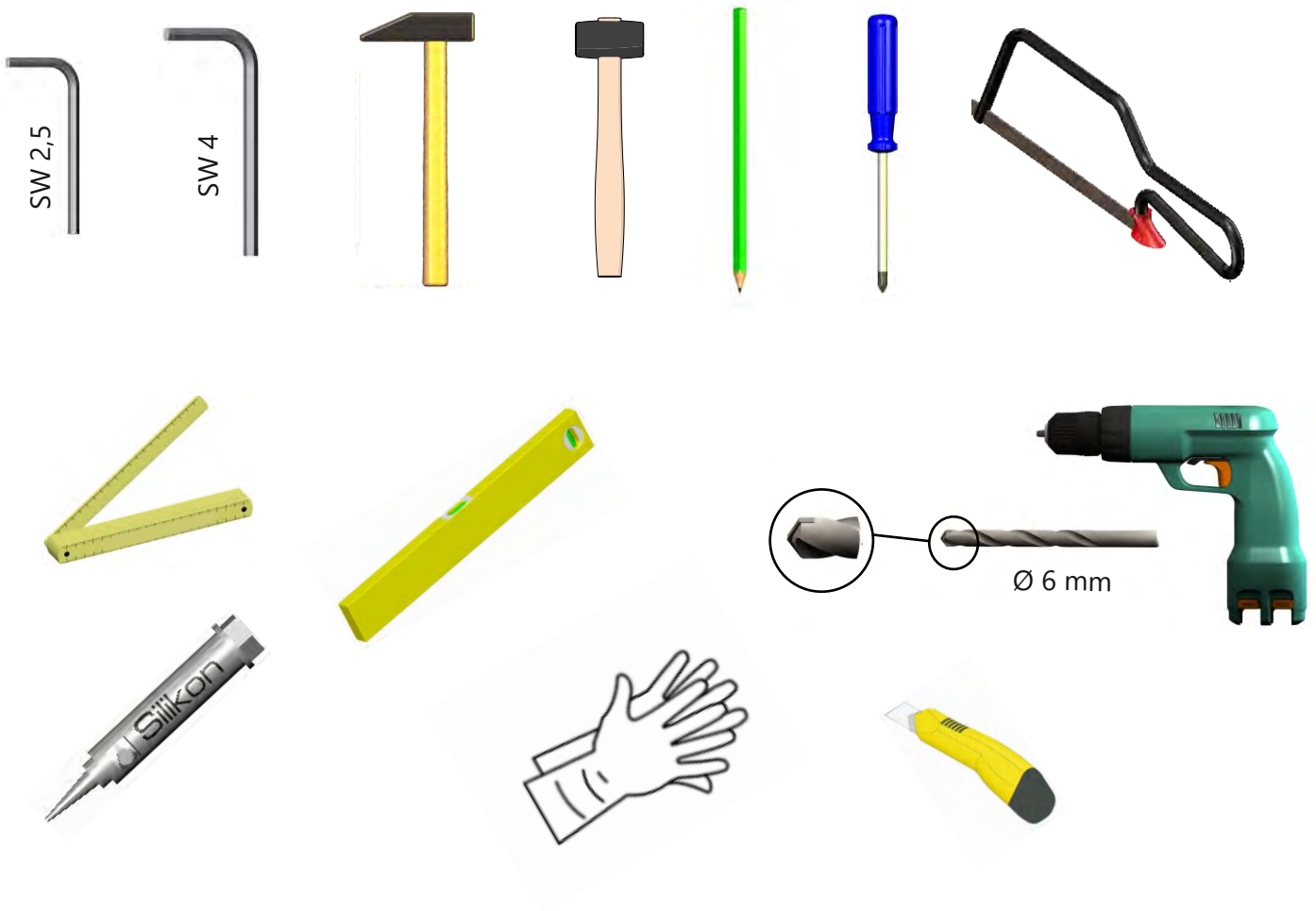



Achtung ! Gläser niemals ungeschützt auf den Boden stellen.
Verletzung der Glaskante führt zu Glasbruch.

Caution ! Never put glass walls on the floor without protection.
Damaging the glass edges results in breaking of the glass.

Attention ! Jamais plaquer des parois de douche en verre au sol sans protection. Des verres endommagés casseront.

EckEinstieg -- Seite 4-5+9
corner entry -- page 4-5+9
entrée d'angle -- page 5+9

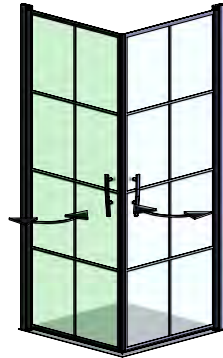

ZBL100-0800		ZBL100-0800
ZBL100-0900	+	ZBL100-0900
ZBL100-1000		ZBL100-1000

FrontEinstieg -- Seite 4-7+9
front entry -- page 4-7+9
entrée avant -- page 4-7+9

ZBL100-0800		ZBL900-0800
ZBL100-0900	+	ZBL900-0900
ZBL100-1000		ZBL900-1000
		ZBL900-1200
		ZBL900-1400

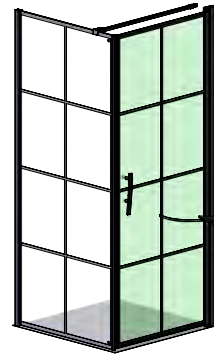
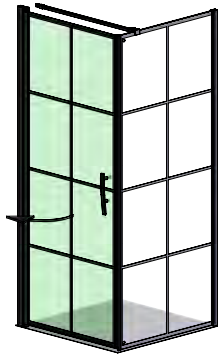

ZBL900-0800		ZBL100-0800
ZBL900-0900	+	ZBL100-0900
ZBL900-1000		ZBL100-1000
ZBL900-1200		
ZBL900-1400		

Nische -- Seite 4-5 + 8-9
niche -- page 4-5 + 8-9
niche -- page 4-5 + 8-9

ZBLAN2000	+	ZBL100-0800
		ZBL100-0900
		ZBL100-1000

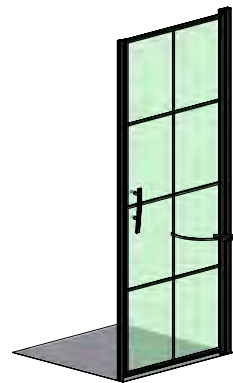
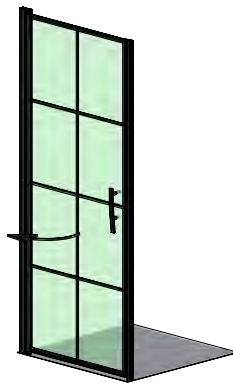

ZBL100-0800		ZBLAN2000
ZBL100-0900	+	
ZBL100-1000		

Walk-In -- Seite 6-7
walk-in -- page 6-7
walk-in -- page 6-7

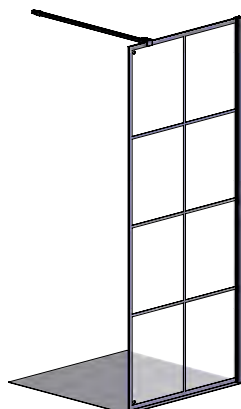

ZBL900-0800
ZBL900-0900
ZBL900-1000
ZBL900-1200
ZBL900-1400

ZBL100-0800
ZBL100-0900
ZBL100-1000



Achtung ! Gläser niemals ungeschützt auf den Boden stellen.
Verletzung der Glaskante führt zu Glasbruch.

Caution ! Never put glass walls on the floor without protection.
Damaging the glass edges results in breaking of the glass.

Attention ! Jamais plaquer des parois de douche en verre au sol sans protection. Des verres endommagés casseront.

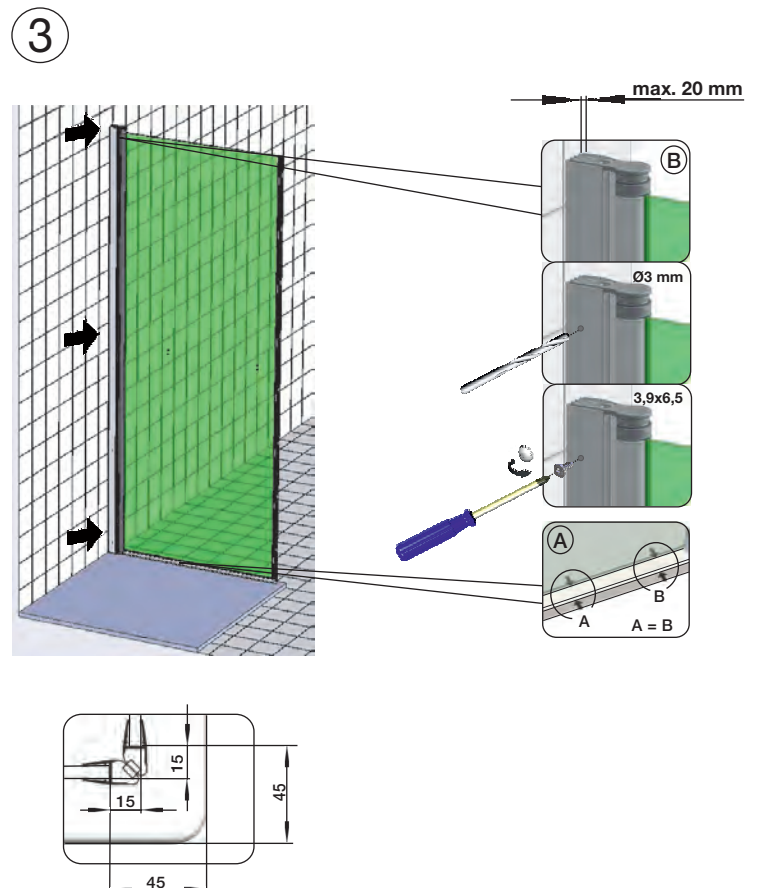
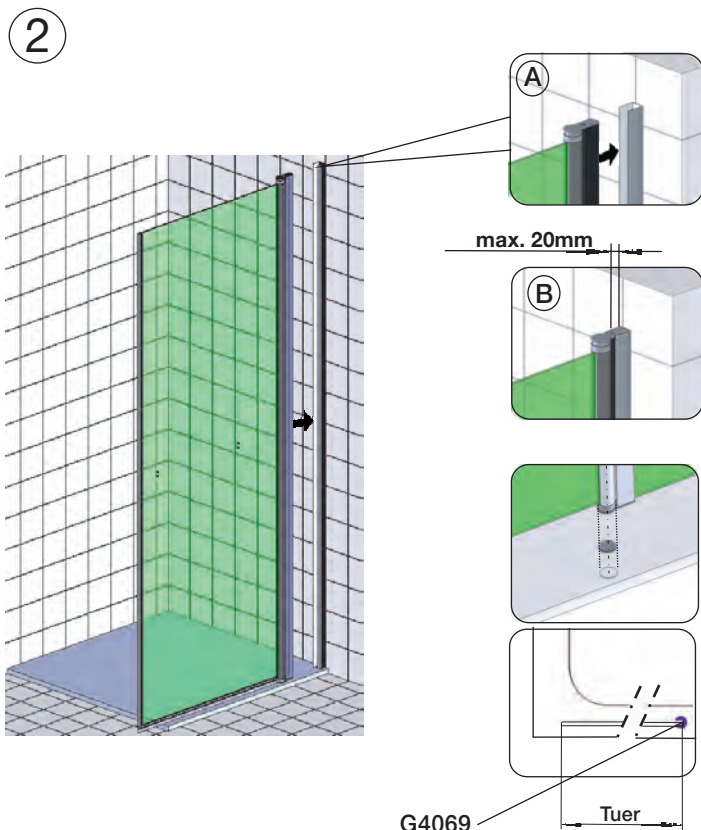
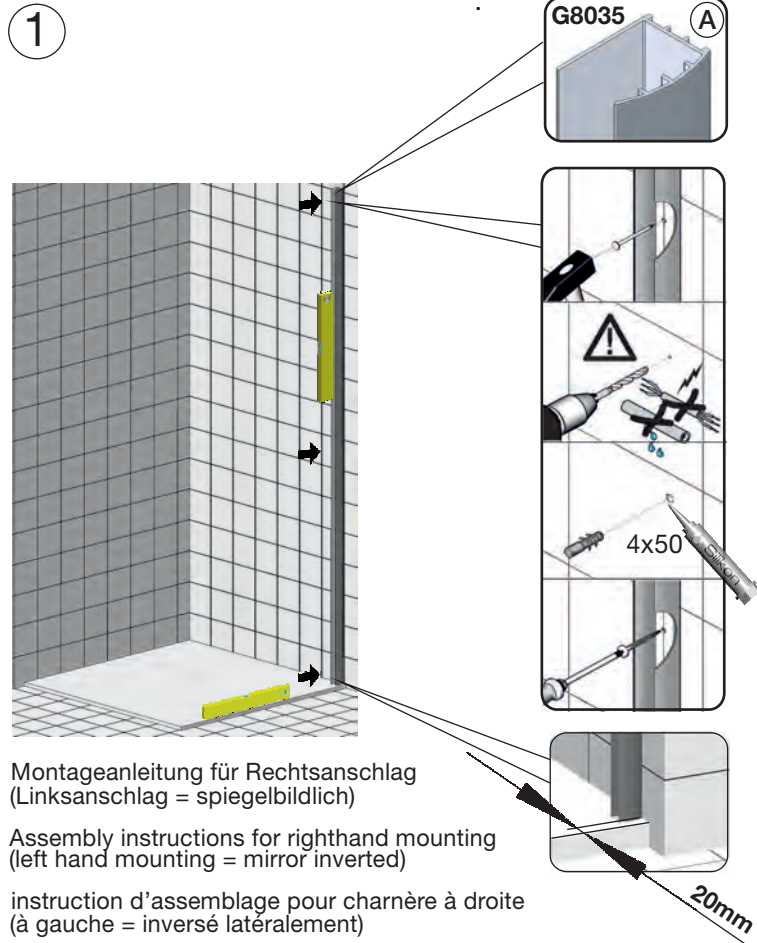
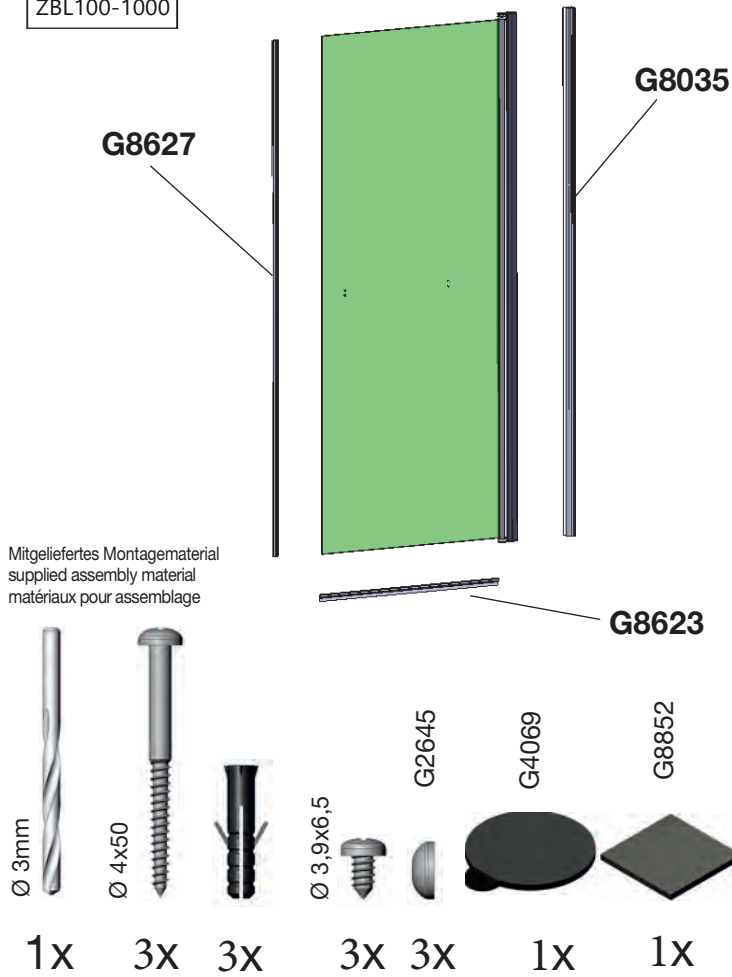

ZBL100-0800
ZBL100-0900
ZBL100-1000



Achtung ! Gläser niemals ungeschützt auf den Boden stellen.
Verletzung der Glaskante führt zu Glasbruch.

Caution ! Never put glass walls on the floor without protection.
Damaging the glass edges results in breaking of the glass.

Attention ! Jamais placer des parois de douche en verre au sol sans protection. Des verres endommagés casseront.

4

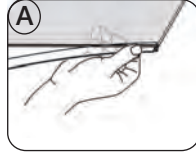
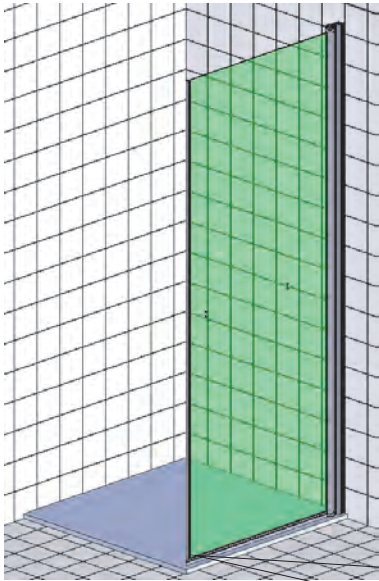

G8623

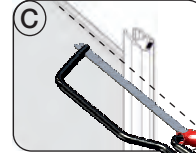

G8627

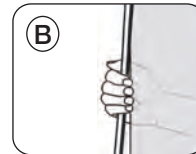

G8627

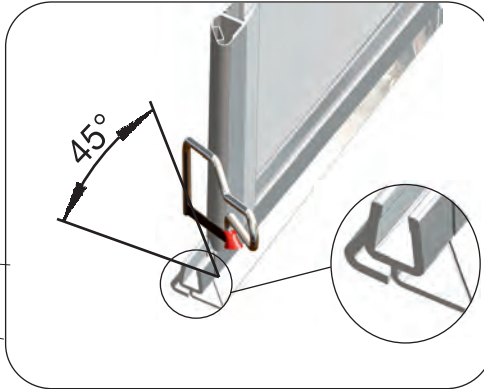

5

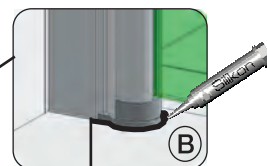
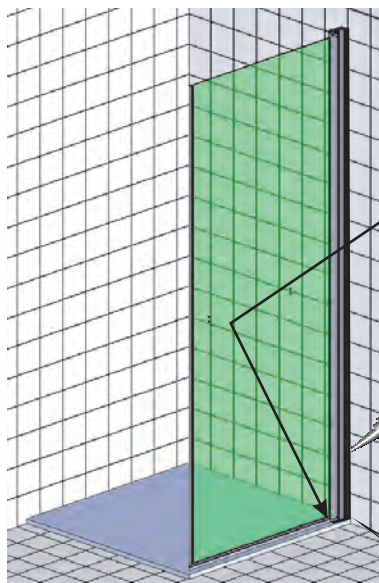

STOP !

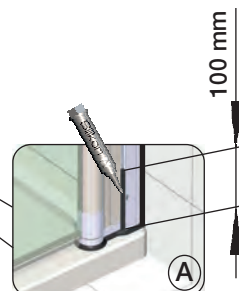

100 mm

ZBL900-0800	ZBL900-1200
ZBL900-0900	ZBL900-1400
ZBL900-1000	



Achtung ! Gläser niemals ungeschützt auf den Boden stellen.
Verletzung der Glaskante führt zu Glasbruch.

Caution ! Never put glass walls on the floor without protection.
Damaging the glass edges results in breaking of the glass.

Attention ! Jamais placer des parois de douche en verre au sol sans protection. Des verres endommagés casseront.

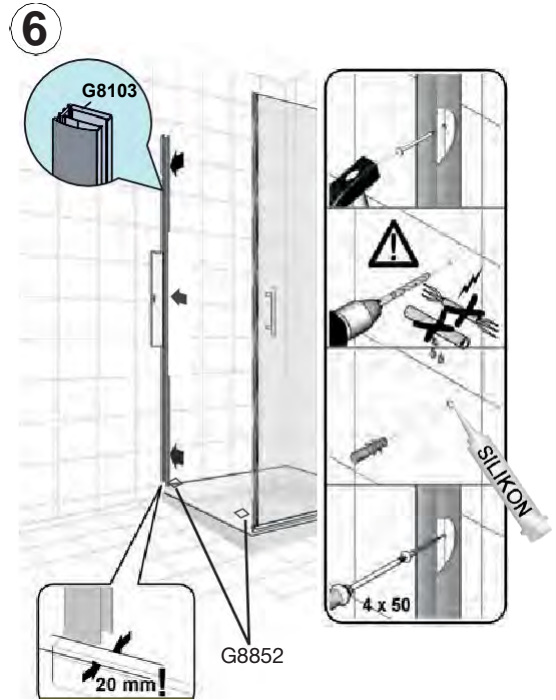
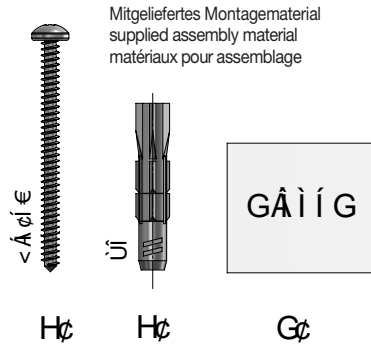
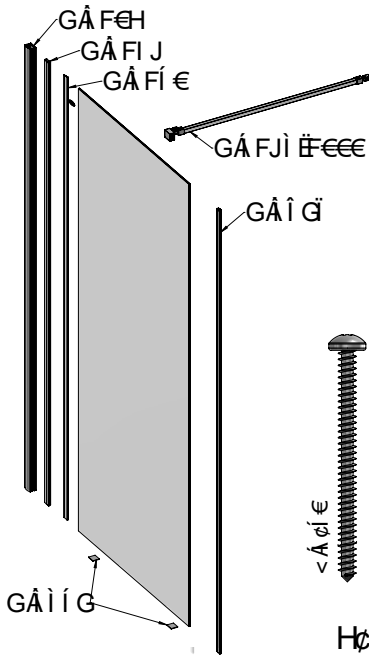

7

G 8627: immer auf Unterseite abschneiden
always cut from the bottom
toujours couper par le bas

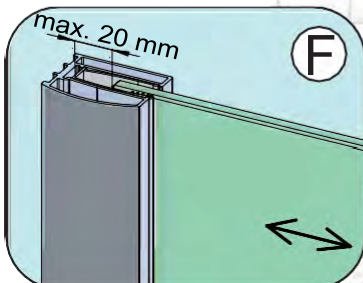
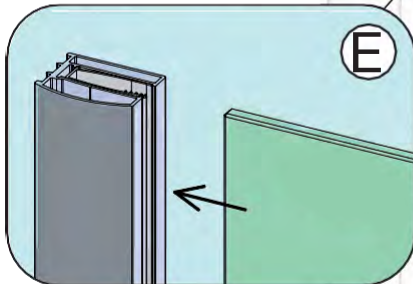
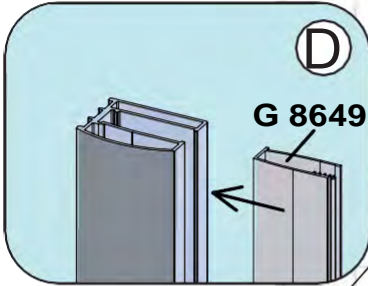
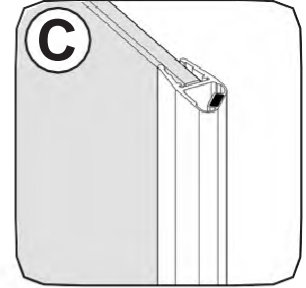
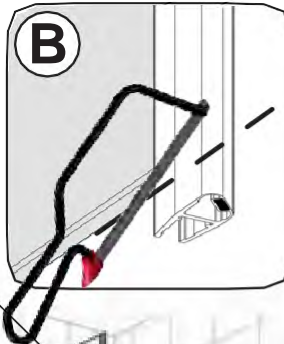

oben / top / haute

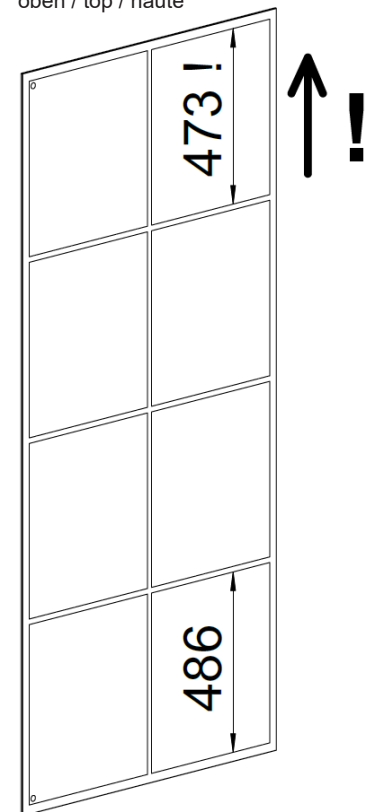

BF1-N100 / BF1-F100 / BF1-E100 / BF1-W001

ZBL900-0800
ZBL900-0900
ZBL900-1000
ZBL900-1200
ZBL900-1400



Achtung ! Gläser niemals ungeschützt auf den Boden stellen.
Verletzung der Glaskante führt zu Glasbruch.

Caution ! Never put glass walls on the floor without protection.
Damaging the glass edges results in breaking of the glass.

Attention ! Jamais placer des parois de douche en verre au sol sans protection. Des verres endommagés casseront.

8

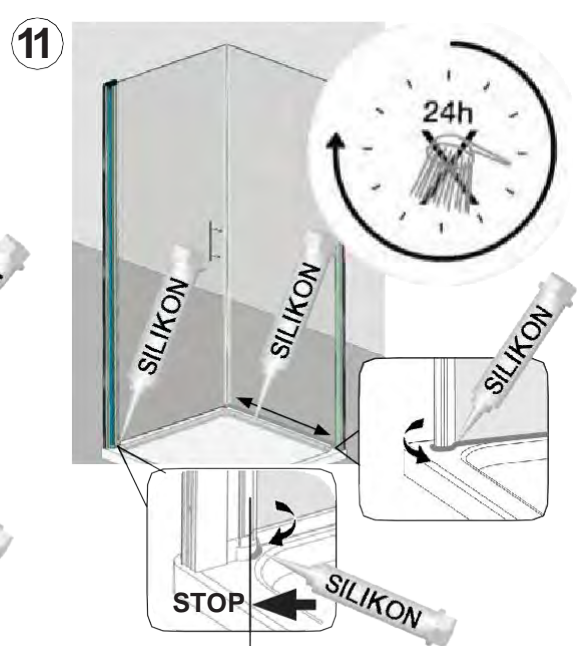
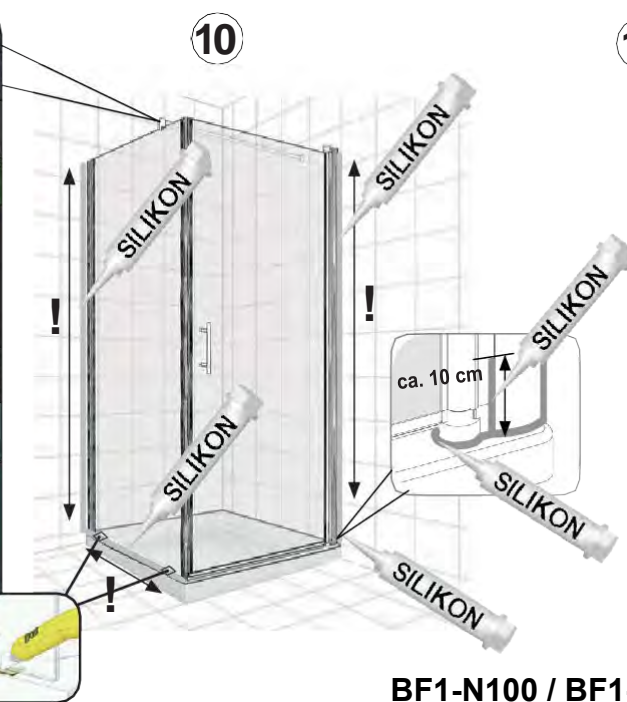
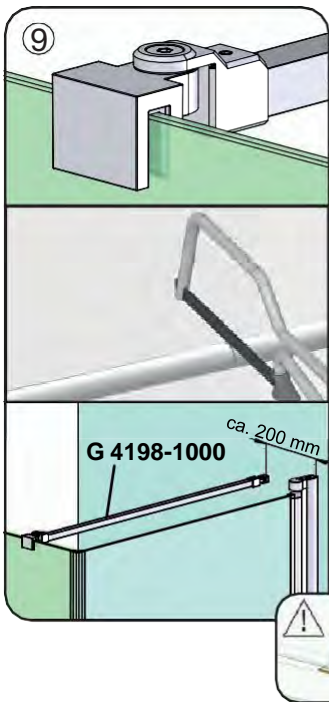
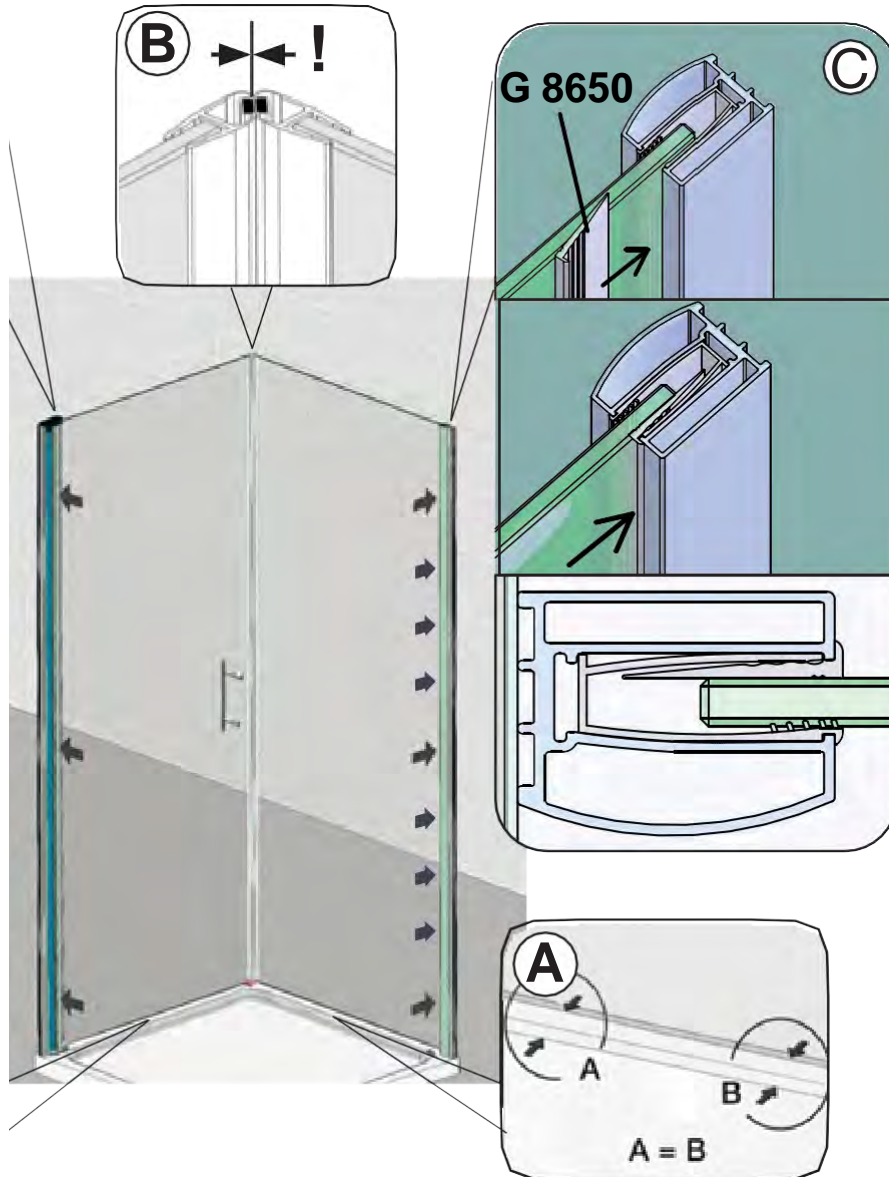

BF1-N100 / BF1-F100 / BF1-E100 / BF1-W001



Achtung ! Gläser niemals ungeschützt auf den Boden stellen.
Verletzung der Glaskante führt zu Glasbruch.

Caution ! Never put glass walls on the floor without protection.
Damaging the glass edges results in breaking of the glass.

Attention ! Jamais placer des parois de douche en verre au sol sans protection. Des verres endommagés casseront.

Mitteliefertes Montagematerial
supplied assembly material
matériaux pour assemblage

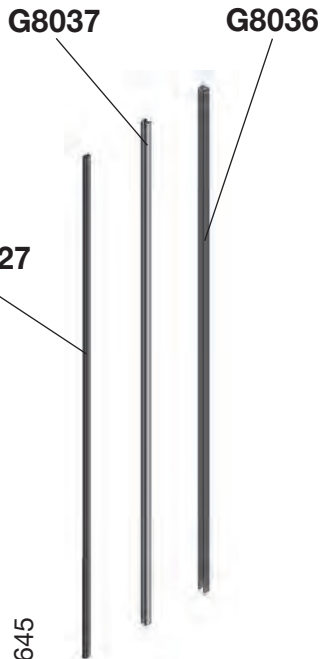
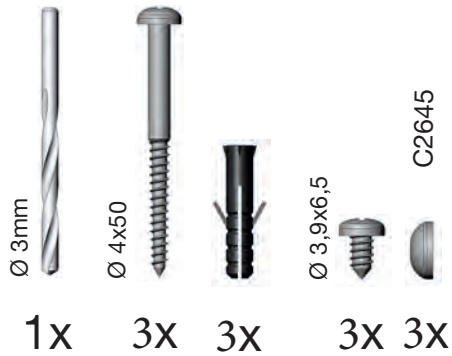

1

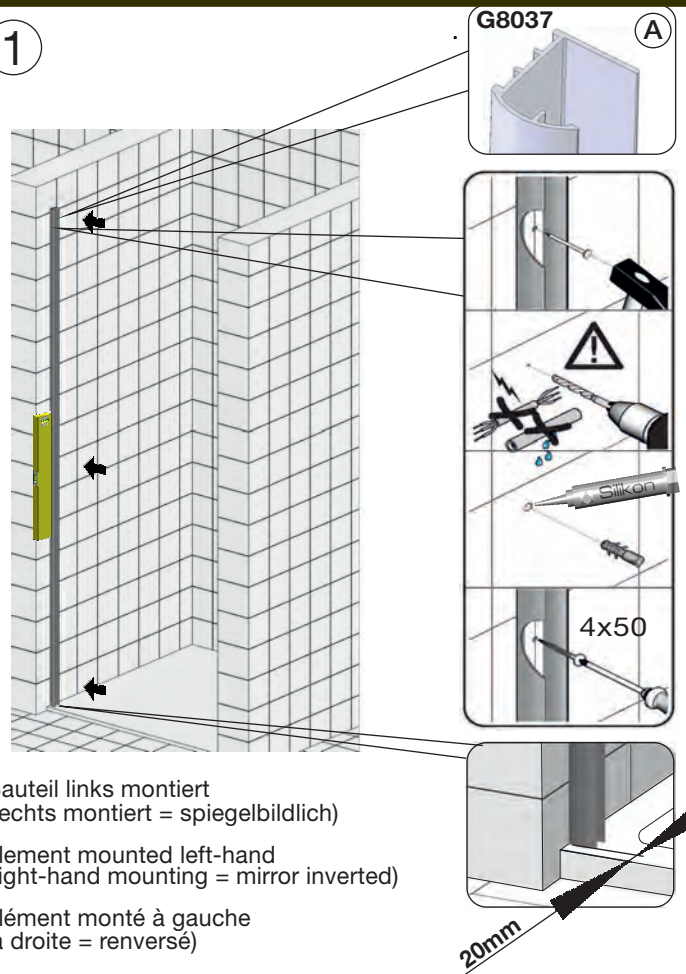

2

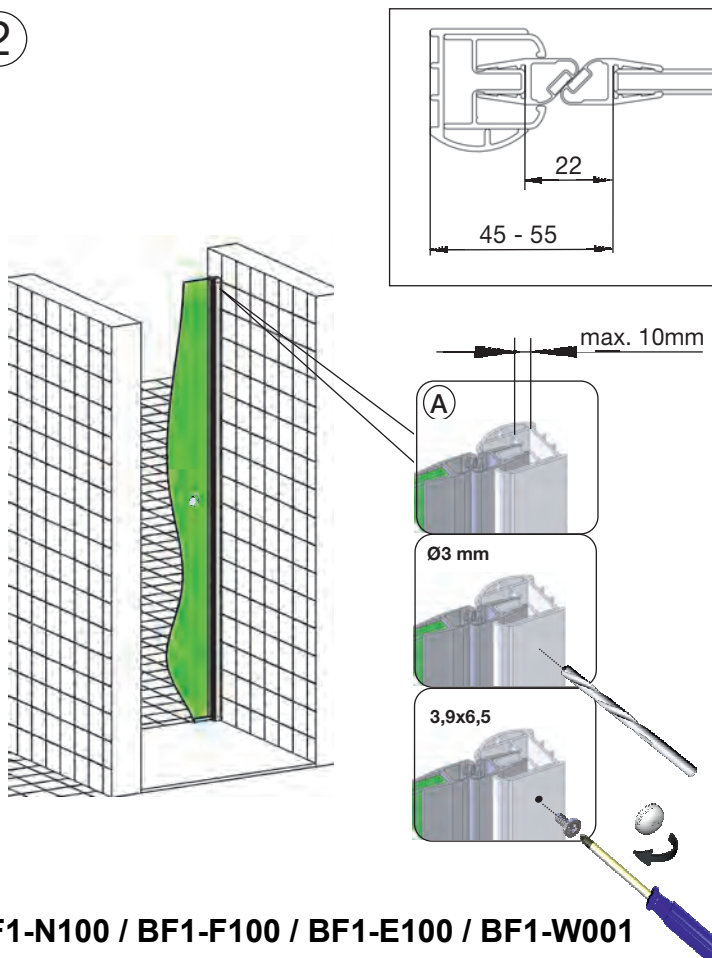

3

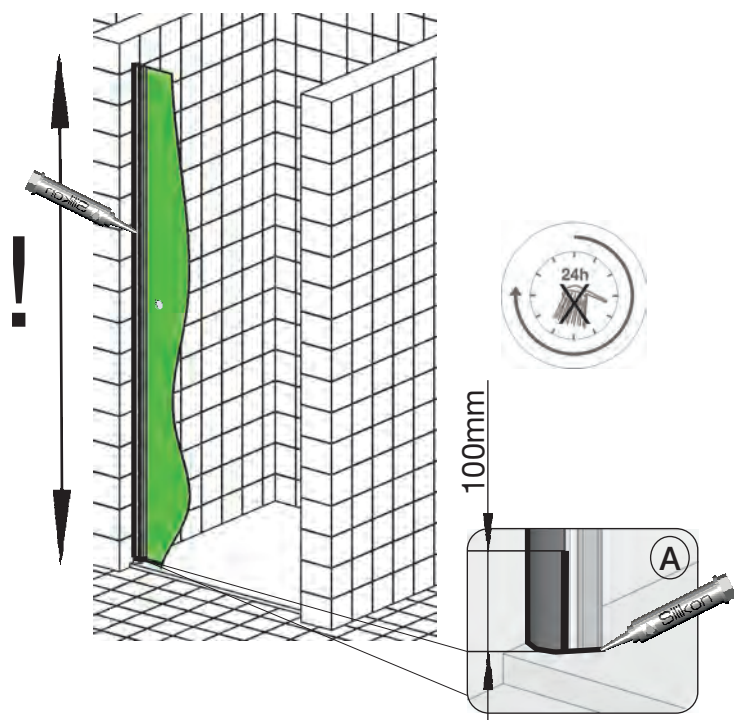



Achtung ! Gläser niemals ungeschützt auf den Boden stellen.
Verletzung der Glaskante führt zu Glasbruch.

Caution ! Never put glass walls on the floor without protection.
Damaging the glass edges results in breaking of the glass.

Attention ! Jamais plaquer des parois de douche en verre au sol sans protection. Des verres endommagés casseront.

Nischenmontage / MOUNTING WALL TO WALL

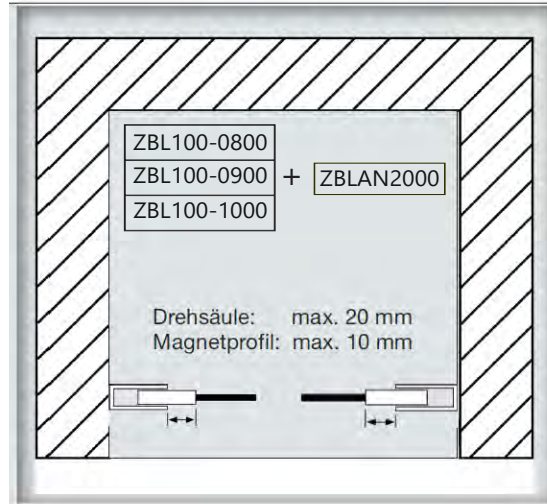

Montage Fronteinstieg mit Seitenteil / Eckeinstieg / MOUNTING FRONT ENTRY/CORNER ENTRY

Montage auf Duschtasse

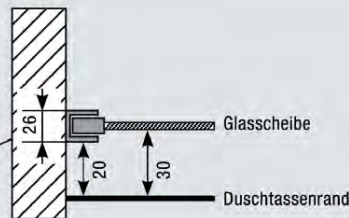
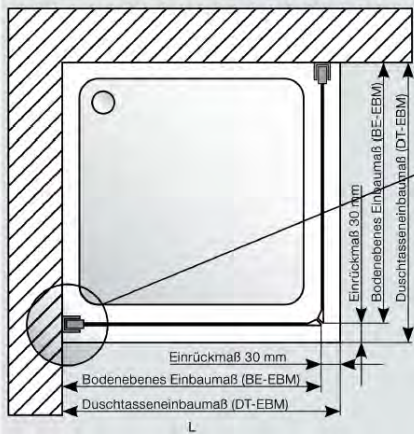

DT	DT-EBM	BE-EBM
800	785 - 805	755 - 775
900	885 - 905	855 - 875
1000	985 - 1005	955 - 975
1200	1185 - 1205	1155 - 1175
1400	1385 - 1405	1355 - 1375

Montage Bodeneben

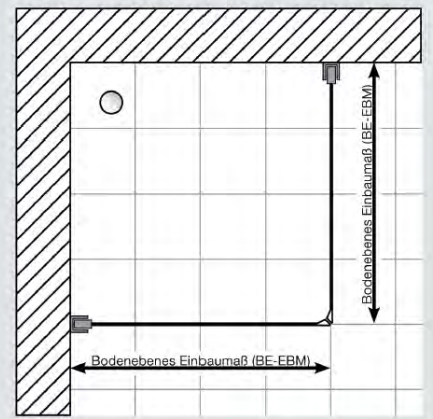

EG-Konformitätserklärung

EC Declaration of Conformity

Hersteller/ Name und Adresse: GEO Produkte GmbH
Friedrichsfelder Straße 27
68723 Schwetzingen

Wir erklären in alleiniger Verantwortung:
We declare under our sole responsibility:

Produktbenennung: Duschtabtrennung mit ESG
oder Kunststoffglas
product designation: shower enclosure with tempered glass and acrylic-glass

Typ / Modell: alle Modelle
type / model: all models

stehen in Übereinstimmung mit den Bestimmungen der im Folgenden
genannten Richtlinie und Standards:
are in conformity with the provisions of the following regulations and standards:

EN 14428:2004 + A1:2008



GEO Produkte GmbH
Friedrichsfelder Straße 27
68723 Schwetzingen /Germany
Tel. +49(0)6202 20930
FAX +49(0)6202 209399

13

DE2013/01

www.geoprodukte.com/service/leistungserklärung.html/

EN 14428

Duschtabtrennung mit Einscheiben Sicherheitsglas oder Kunststoffglas
Shower wall made of *ESG tempered safety glass or sythetic glass*

Reinigbarkeit:
cleanability: Bestanden
passed

Bruch Eigenschaften:
impact resistance: Bestanden
passed

Dauerhaftigkeit:
durability: Bestanden
passed

GEO Produkte GmbH • Friedrichsfelder Straße 27 • 68723 Schwetzingen/Germany
Telefon +49 (0)6202 2093-0 • Fax +49 (0)6202 2093-99 • **www.geoprodukte.com** • info@geoprodukte.com
Technische Hotline: +49 (0)6202 2093-42 • Mo-Fr 7:00h - 20:00h • Samstag 9:00h - 15:00h